

TRIPLATE

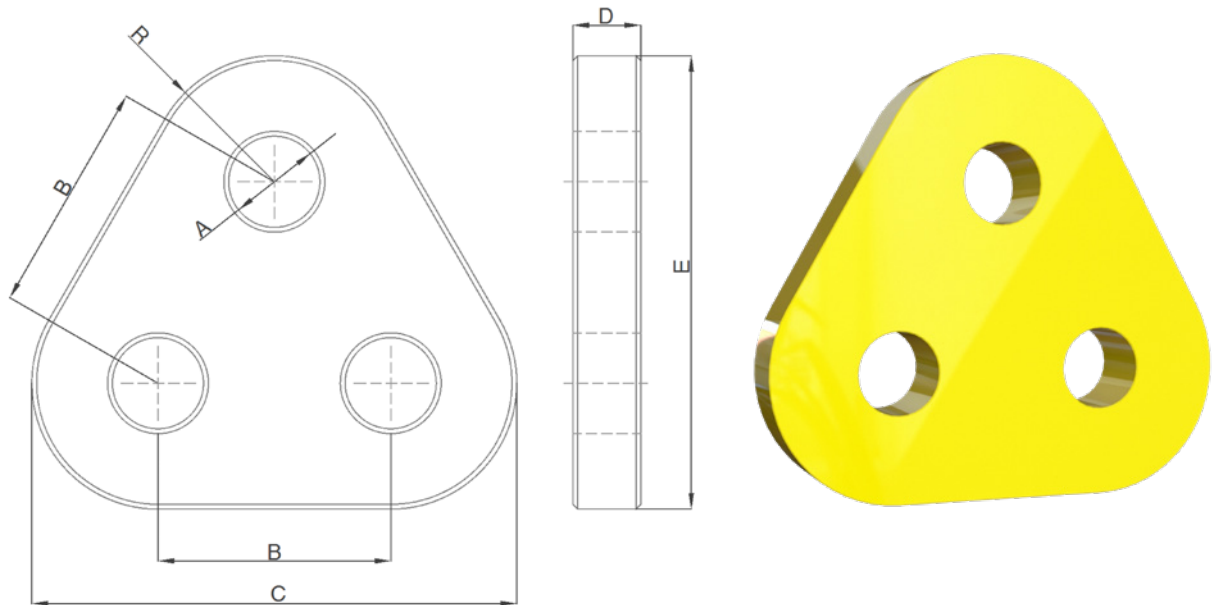

- WLL: from 120t to 700t.
- Triplates forged, heat treated and machined.
- Material: carbon steel, alloy and super alloy. Most regular super alloy steel (R4)
- Coating Protection: upon request.
- Safety Factor: min. 4:1.
- Load Test: requested and recommended. ILO-3, FAT or Breaking Test available upon request.
- Certificate: EN10204-3.1. For 3.2, Mooring Accessory Cert with ABS and DNV upon request.

CONNECTORS STANDARD TRIPLATE							
Overall dimensions (mm)							Weight
WLL (t)	A	B	C	D	E	R	kg
120	105	280	620	100	582	170	188
150	115	320	690	110	647	185	256
175	115	320	710	110	667	195	274
200	140	390	820	120	768	215	390
250	150	390	870	140	818	240	518
300	160	420	920	150	864	250	617
400	185	490	1090	200	1024	300	1170
500	200	550	1270	200	1196	360	1619
600	220	600	1400	200	1320	400	1972
700	230	600	1400	250	1320	400	2452

Tolerances: machined surface tolerance +/-1%. +/-5% for D dimension.